

The Swix logo is located in the top right corner of the page. It consists of the word "swix" in a white, italicized, sans-serif font, set against a solid red rectangular background.

Base Prep & Waxing Guide

FOR ALPINE, FREERIDE AND SNOWBOARD



ALPINE SKI AND SNOWBOARD PREPARATION

PERFORMANCE USER LEVEL

This is the level for alpine skiers and snowboarders who use their equipment often and want to get the most out of their equipment. The focus is on achieving “the optimal feel”.

STEEL EDGE AND BASE TREATMENT WITH SWIX PRODUCTS

In a few simple steps, you can prep your skis or snowboard to gain higher performance from your equipment. These simple steps can help you improve the glide and turning properties of your equipment significantly, and should also give you greater confidence that your equipment will optimise your skiing experience. The greatest benefits come when skiing on hard surfaces.

New skis and snowboards

New skis and snowboards that have not been pre-treated at the shop should be given a base treatment before use. A base treatment ensures the best possible starting point for the original surface coating and improves glide properties. The edges should also be sharpened in order to ensure the best possible carving properties on snow and ice. Sharpened steel edges provide you with better control and feel when turning, and is like putting new tires on your car – the equipment will be more responsive and tuned to your body, and you will gain more confidence in your skiing abilities.

When prepping skis and snowboards, a vise will help you work more easily and efficiently. We recommend T0149-20 for alpine skis and SB031NO for snowboard. For alpine skis retract the ski brakes with the T0165 Brake Retainer.

ADVICE:

When treating the surface and steel edges, always start by prepping the edges first, which will ensure that you avoid getting wax on the filing tools. When the ski or snowboard is new, start the preparation by establishing the edge geometry (edge bevels). The key to obtaining optimal carving properties on snow and ice is to ensure that the edges are as smooth and even as possible.



T0149-20 Alpine Ski Vise



SB031NO Snowboard Vise



T0165 Ski Brake Retainer



R0392 Ski Straps

IMPORTANT AREAS WHEN PREPPING EDGES

BASE EDGE:

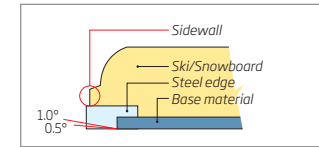

Generally 0.5 to 1 degree bevel



TA3009



Base-edge filing

SIDE EDGE:

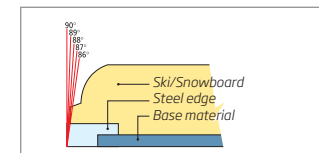

Generally 87 to 88 degree bevel

SIDEWALL:

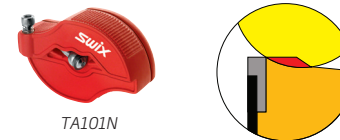

TA101N



Removing sidewall offset

Base edge:

- Make sure that the base edge is level with the base surface. Scraping the base surface is more difficult if the edges are too high, and this may also cause problems steering (erratic “hooking” effect). By beveling the base edge 1 degree, the edges will not grab immediately when you are skiing, but you will gain control progressively, which will allow you to turn your skis or snowboard more easily.

- Place the ski or snowboard in the horizontal position in the vise (base up).

- For coarse filing of the base edge, use TA3009. Put the file in position for filing the base edge. If you mark the edges with a marker before you start, you can see the effect the file is having. Bevel the base edge 1 degree (see illustration). Using overlapping movements, file by moving the file holder from the tip to the tail.

Side edge and sidewall:

- Place the ski or snowboard in the ski vise in a vertical position and with the base facing away from you.

- In order to obtain optimal carving properties on snow and ice, bevel the side edge 3 degrees, which will produce a sharper angle between the base edge and side edge (see illustration).

- Before coarse filing the side edge, we recommend that you remove some of the sidewall offset (see illustration); this will allow you to avoid filing the sidewall with the file and to focus your efforts on filing the steel edge. Use the special tool Swix TA101N. You will have to repeat this procedure periodically when the side edge is filed down to the point where the sidewall and side edge are even. Make sure to not remove too much at a time.

SIDE EDGE FILING:



TA3009

Generally 2 to 3 degrees resulting in a total edge angle of 87 to 88 degrees

- Now you can start coarse filing the side edge. Fasten the file in the holder in the appropriate position for working on the side edge. File from the tip to the tail, using a pattern of overlapping strokes. Generally 2 to 3 degrees resulting in a total edge angle of 87 to 88 degrees.



Removing burred steel from filing with a diamond stone



TAA200N

Removing burred steel from filing:

- When coarse filing the edge, burrs can develop on the edge. Unless such burrs are smoothed off, the edge will become rounded and duller more quickly.

- Use the diamond stone TAA200N. Work with the stone back and forth along the entire side edge and base edge (see illustration). The edges should now be sharp and polished without any irregularities.



Maintenance of edges with a diamond stone



TAA200N

Maintaining sharpness of edges:

- As with knives, it is not necessary to use a file every time you need to sharpen the steel edges. A diamond stone, TAA200N can be used instead (see illustration). Using such a tool will save time and the result is usually excellent. If you still feel that the edges are not sharp enough, then apply the file in the same manner as described in the base treatment of the edges.

Rounding/dulling of edges in front and back:

- Some prefer to dull or detune the edges in the front and back sections of the skis or snowboard. If you feel that the tip cuts out to the inside at the start of a turn too quickly, then you can round the edge on both sides of the tip. Use the diamond stone TAA200N and dull the edge in the "shovel" area from the point of snow contact and forward. Do the same procedure at the tail section of the ski or board, approx. 2 inches. If you want to take advantage of the entire turning curve on the skis/ snowboard or want to optimise use of the front section, then there is no need to dull the tip and tail sections. Depending on skill level, technique and application, some prefer this alternative.



Removing cuts in edges with a diamond stone



TAA200N

Removing nicks and cuts in edges:

- In order to achieve satisfactory carving properties on snow and ice, the edges must be smooth and without any nicks or cuts. Damage to the steel edges are most often caused from hitting rocks. When this happens, the edges of the damaged spot become hardened. When you start filing, you will notice that the file will skid and you will have problems repairing the damage. In order to eliminate the hardened top layer, use diamond stone TAA200N, which must be dipped in water.

- Use the stone on the base edge and side edge at the damaged site. Then pass over the spot with a file on both sides of the edge. The file should be filing better now. Finish off with the diamond stone in order to even out and polish the edge.

CONVENIENT CASES



Edge Kit for alpine/freeride/snowboard (T0065)

Contains what is needed to maintain Side Edge and Base Edge on a high level. Ideal for national racers: Young racers (or their parents); old racers (masters).

Contains:
TA287 Side edge file guide 87°, TA005 Base edge file guide 0.5°, T106N File Second Cut, TA101N Sidewall cutter, TAA400N Diamond stone, TA022 Clamp, T0165 Ski break holder, T0177B File brush.

Additional space for I84-150C Glide wax cleaner or I62C Base cleaner.



Base and Glide Wax Kit (T0067)

Contains tools and waxes to have a fast base. Ideal for national racers: Young racers (or their parents); old racers (masters). For alpine, freeride, snowboard and cross country.

Contains:
T0823D Scraper, T0162B Bronze Brush, T0160B Finish Blue Nylon Brush, T0087 Scraper for side-walls, 1 sheet T266N Fibertex, violet, I84-70C Glide wax cleaner, T0151 Fiberlene, 60g: CH6X, CH7X, CH8X, CH10X 180g: LF6X, LF8X

CLEANING AND SATURATION WAXING



I84-70C

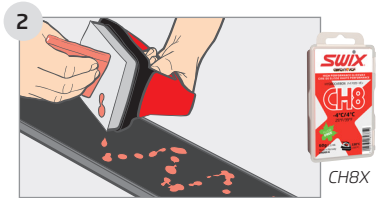

CH8X

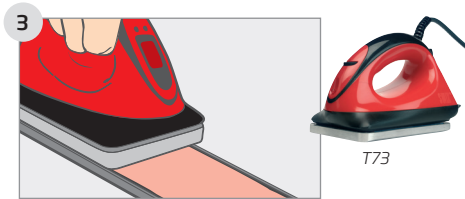

T73

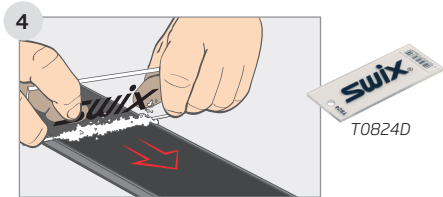

T0824D

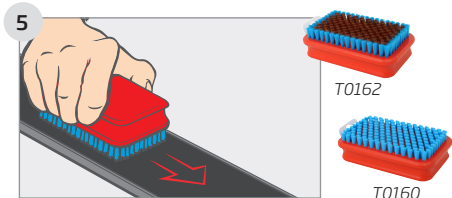

T0162

T0160

1
You need to clean the surface of the ski or snowboard if it comes straight from a store or after having sharpened the edges. Brush the base lightly with a Bronze Brush (T0162B). Moisten a piece of Fiberlene with the Glide Wax Cleaner (I84-70C) and apply to the base. Rub forward and backward a few times with a Nylon Brush (T0161B) and wipe off as much as possible with Fiberlene. Let the ski dry for 5-10 minutes. Brush firmly with the Bronze Brush (T0162B). The ski is now ready for application of glide wax.

2
Use a soft, warm temperature wax such as Swix CH8X with waxing iron T73. Softer waxes are used for base treatment because these waxes penetrate deeper. Drip the wax in a zigzag pattern and then spread it evenly across the surface with the waxing iron.

3
Move the iron from the tip to the tail with even passes. Do not stop in the middle of a pass. Complete 3 passes across the entire surface. Be careful to use the recommended temperature on the iron as specified on the wax package. Let the ski or snowboard cool to room temperature, approx. 10 minutes.

Repeat the procedure 3 times without scraping off the wax. Make sure that the waxing iron has enough wax to glide smoothly across the surface.

4
Scrape off the excess wax while it is still hot with a plexi scraper T0824D, which will clean the surface even more. Do not press the scraper hard against the surface. If the scraper is dull, then it can be sharpened with plexi sharpener T410.

5
Brush the surface with a bronze brush T0162 from the tip to the tail (see illustration). Brush approx. 10 passes with an overlapping movement. Finish off with the blue nylon brush T0160.

TWO WAYS TO WAX ALPINE SKIS AND SNOWBOARDS!

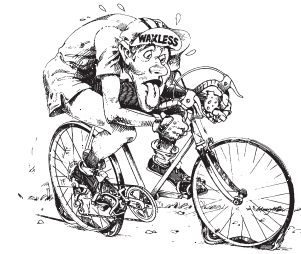

“Poor glide when skiing is like bicycling with a flat tire”. By selecting a wax matching the day’s temperature and snow conditions, you will ensure that you have a better ski experience – you will glide faster across flat sections and turn much easier as well.

1. THE “EXPRESS METHOD” OF WAXING



F4-100WC

F4-100CC

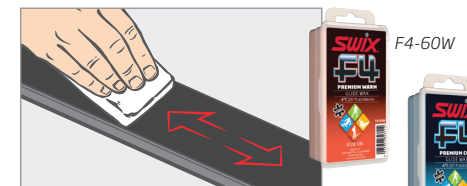

F4-60W

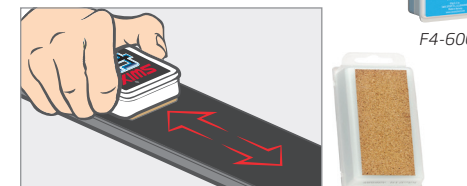

F4-60C

Swix F4 Premium is based on formulas featured in the most award-winning glide-wax system in history – “Swix Cera Nova”.

FOLLOW THESE EASY STEPS:

Liquid performance wax:

- Select the wax that matches the day’s air temperature (in the shadow).
- Shake the bottle and then press it against the base. Distribute evenly.
- Let the wax dry for about 3 minutes before skiing.

Rub on performance wax:

- Select the wax that matches the day’s air temperature (in the shadow).
- Rub the wax onto the entire base.
- Cork in with the cork on the back.

Remember:

The general rule is that liquid/rub on wax does not last as long as when using a waxing iron.

2. THE PROFESSIONAL METHOD OF WAXING

1



For this approach, we recommend the Cera NovaX system (CHX or LFX waxes).

1

Select the wax that matches the day's air temperature in the shadow.

2

Set the temperature of the waxing iron in accordance with the instructions on the packaging of the selected wax.

2



3

Drip the wax in a zigzag pattern on the surface (see illustration). The temperature on the waxing iron is ideal when the wax drips relatively quickly, but does not run. The wax must not become so hot that it emits smoke.

3



4

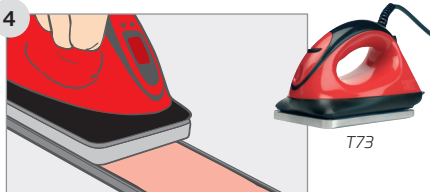

4

Move the iron from the tip to the tail with an even and steady pass. Do not stop while making the passes. Complete 3 passes across the entire surface. Let the ski or snowboard cool down to room temperature for approx. 10 minutes.

5

Scrape off excess wax with a plexi scraper T0824D (see illustration). Use light pressure when you do this. Start from the front and scrape in an overlapping pattern from tip to tail.

5

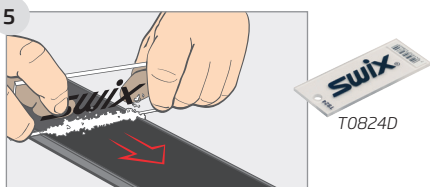

6

Brush the surface with a bronze brush T0162 (or T0159) from the tip to the tail (see illustration). Brush approx. 10 passes with an overlapping movement and moderate pressure. End by brushing with a blue nylon brush T0160.

6

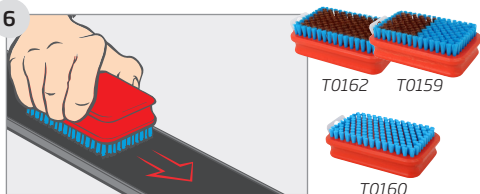

swixschool.com

